

## 2.3 a) Twin p Rozmery

**TWIN-P 07**

PR ▲

Základová doska pre medzivzpery

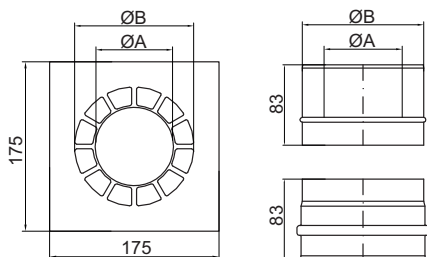

Ø	60	80	110	<-- vnútorný
kg				
Ø	110	125	160	<-- vonkajší
kg				

**TWIN-P 10**

PR ▲

Predĺženie s kontrolným otvorom

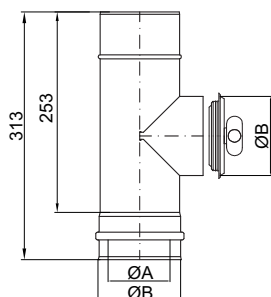

Ø	60 / 100	80 / 125	110 / 160
A	60	80	110
B	100	125	160
kg			

**TWIN-P 13**

PR ▲

Predĺženie 1000 mm

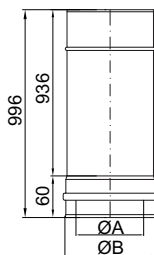

Ø	60 / 100	80 / 125	110 / 160
A	60	80	110
B	100	125	160
kg			

**TWIN-P 14**

PR ▲

Predĺženie 500 mm

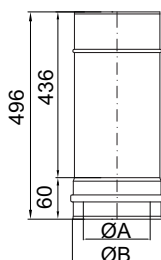

Ø	60 / 100	80 / 125	110 / 160
A	60	80	110
B	100	125	160
kg			



## TWIN-P 15

PR ▲

Predĺženie 250 mm

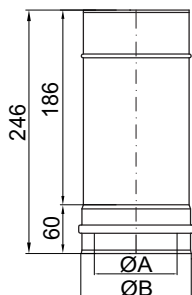

Ø	60 / 100	80 / 125	110 / 160		
A	60	80	110		
B	100	125	160		
kg					

## TWIN-P 11

PR ▲

T-kus 87° s kontrolným viečkom

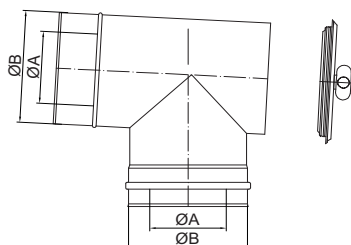

Ø	60 / 100	80 / 125	110 / 160		
A	60	80	110		
B	100	125	160		
kg					

## TWIN-P 308

PR ▲

T-kus 87° s kontrolným viečkom vrátane integrovanej prípojky kotla

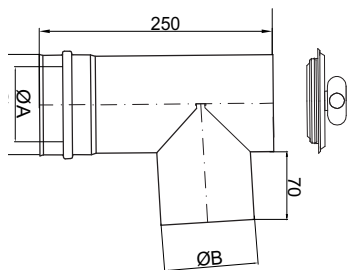

Ø	60 / 100	80 / 125	110 / 160		
A	60	80	110		
B	100	125	160		
kg					

## TWIN-P 32

PR ▲

Uzáver vedenia

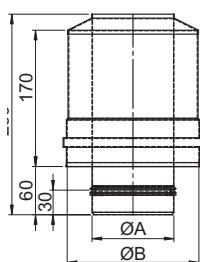

Ø	60 / 100	80 / 125	110 / 160		
A	60	80	110		
B	100	125	160		
kg					

## 2.3 a) Twin p Rozmery

**FU72**

ti = 0,6 - 1,0mm

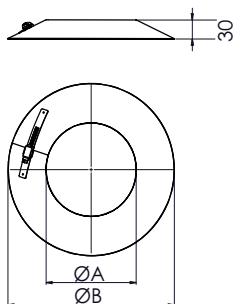

Golier



Ø	60 / 100	80 / 125	110 / 160		
A	60	80	110		
B	90	110	140		
C					
kg	0,20	0,23	2,03		

**TWIN-P  
360**

PR ▲

Strešná prechodka (EPDM) so skrutkami a tesniacou sadou



Ø					
kg					

**TWIN-P  
353**

PR ▲

Strešná prechodka pre betónové škridle červená RAL 8004



Ø					
kg					

**TWIN-P  
354**

PR ▲

Strešná prechodka pre betónové škridle čierna RAL 9005



Ø					
kg					



# ST

<b>TWIN-P 355</b>	PR ▲		

Strešná prechodka univerzál pre betónové škridle  
červená RAL 8004



Ø				
kg				

<b>TWIN-P 356</b>	PR ▲		

Strešná prechodka univerzál pre betónové škridle  
čierna RAL 9005



Ø				
kg				

<b>TWIN-P 357</b>	PR ▲		

Terminál zvislý

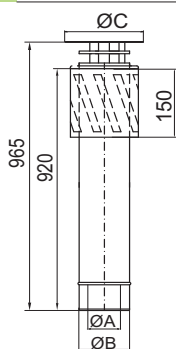

Ø	60 / 100	80 / 125	110 / 160		
A	60	80	110		
B	100	125	160		
C	155	180	215		
kg					

<b>TWIN-P 16</b>	PR ▲		

Koleno 15°

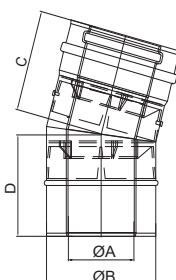

Ø	60 / 100	80 / 125	110 / 160		
A	60	80	110		
B	100	125	160		
C	107	108	110		
D	107	108	111		
kg					

## 2.3 a) Twin p Rozmery

**TWIN-P 17**

PR ▲

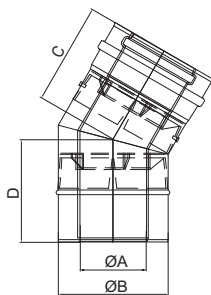

Koleno 30°



Ø	60 / 100	80 / 125	110 / 160		
A	60	80	100		
B	100	125	160		
C	113	117	121		
D	113	116	121		
kg					

**TWIN-P 18**

PR ▲

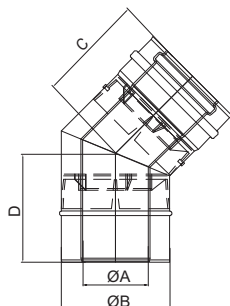

Koleno 45°



Ø	60 / 100	80 / 125	110 / 160		
A	60	80	110		
B	100	125	160		
C	121	126	133		
D	121	126	133		
kg					

**TWIN-P 64**

PR ▲

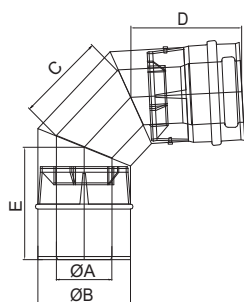

Koleno 87°



Ø	60 / 100	80 / 125	110 / 160		
A	60	80	110		
B	100	125	160		
C	73	83	97		
D	120	125	132		
E	120	125	132		
kg					

**TWIN-P 60**

PR ▲

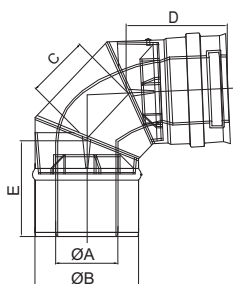

Koleno 90°



Ø	60 / 100	80 / 125	110 / 160		
A	60	80	110		
B	100	125	160		
C	60	75	97		
D	95	103	132		
E	120	125	132		
kg					



## TWIN-P 67

PR ▲

Koleno pevné 87° s čistiacim otvorom

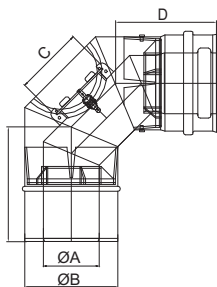

Ø	60 / 100	80 / 125	110 / 160		
A	60	80	110		
B	100	125	160		
C	66	76	78		
D	109	89	100		
E	123	103	95		
kg					

## TWIN-P 19

PR ▲

Koleno pevné 90° s čistiacim otvorom

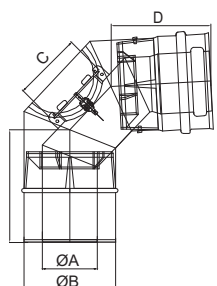

Ø	60 / 100	80 / 125	110 / 160		
A	60	80	110		
B	100	125	160		
C	65	77	97		
D	109	125	132		
E	123	128	132		
kg					

## TWIN-P 181

PR ▲

Prisávanie vzduchu

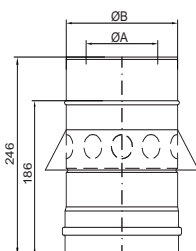

Ø	60 / 100	80 / 125	110 / 160		
A	60	80	110		
B	100	125	160		
kg					

## TWIN-P 51

PR ▲

Merací prvok 200 mm

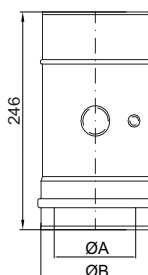

Ø	60 / 100	80 / 125	110 / 160		
A	60	80	110		
B	100	125	160		
kg					

## 2.3 a) Twin p Rozmery

**TWIN-P  
182**

PR ▲

Prípojka kotla bez meracieho otvoru

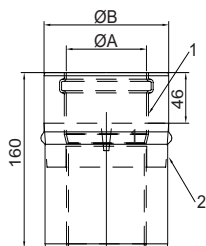

Ø	60 / 100	80 / 125	110 / 160		
A	60	80	110		
B	100	125	160		
kg					

**PP26**

PR ▲

Vnútorné tesnenie

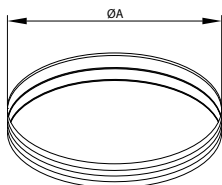

Ø	60 / 100	80 / 125	110 / 160		
A	60	80	110		
kg					

**VL314**

PR ▲

Závitová tyč M8

Ø					
kg					

**TWIN 45**

PR ▲

Spojka

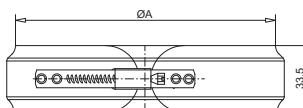

Ø	60 / 100	80 / 125	110 / 160		
A	100	125	160		
kg					



# ST

AL26

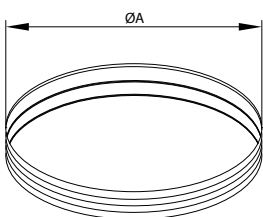

Vonkajšie tesnenie



Ø	60 / 100	80 / 125	110 / 160		
A	100	125	160		
kg					

Twin